

# VanuaView

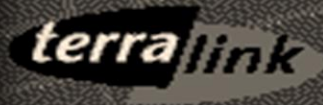

- **VanuaView** was a software that enabled users to view Fiji's GIS data, namely cadastral and topographic.
- It was developed by Terralink NZ and FGIS (formerly known as FLIS) and launched in 1998.



**vanuaview**

**GIS data local land information**

- VanuaView was used throughout Fiji by groups and individuals in both the public and private sector and from various industries, e.g. real estate, surveying and valuation.
- It was a simple application containing layers like contours, rivers and surveyed land boundaries, and it required data updates from FGIS.





**HOW LAND INFORMATION WAS  
COLLECTED & ACCESSED**



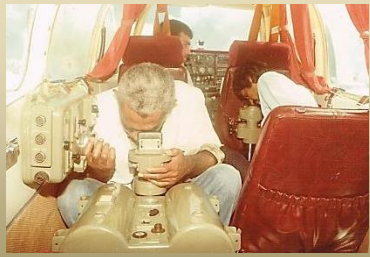

Air Survey



Aerial Photo

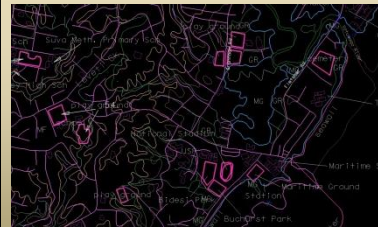

Microstation  
Clip

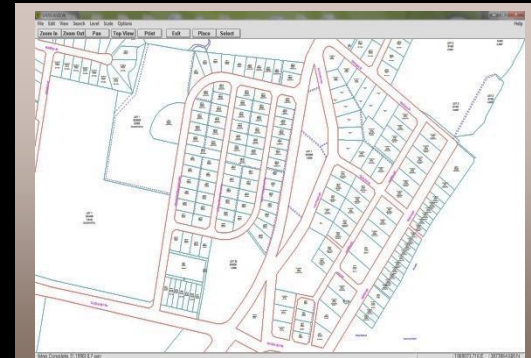

VanuaView



Microstation Clip

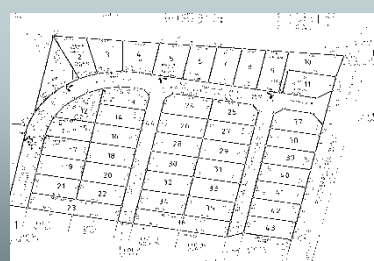

Survey Plan



Field Survey

**Changes in technology and the need for a more versatile GIS application is what led to the development of an entirely web based application.**

**VanuaView underwent reinvention to improve:**

**Security**

**Accessibility & Availability**

**User Friendliness**

**High End Machine Compatibility**

**Versatility & Visibility**

**Spatial Analysis Capabilities**

**Data Standardization**

**Overall Functionality**

- **Prior to VanuaGIS, data was displayed in VanuaView as flat-files, e.g. shapefiles and .dgn files.**
- **VanuaView system moved these to a versioned, multi-user environment with numerous productivity improvements.**



Disconnected  
files

Network  
folders

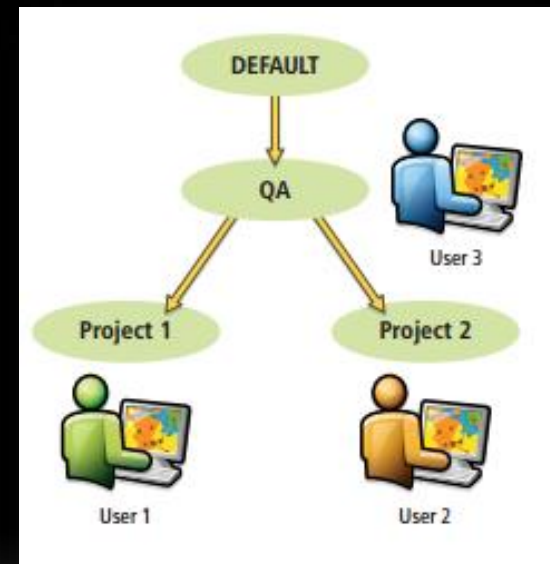
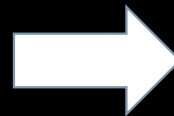

**“Versioned Multiuser Editing”**



**A geospatial response using a collaborative approach and simple to use web technology.**

**Link:**

**<https://vanua.viewonline.fiji/>**

